

Series Spec Sheet

CDHF2

HAZARDOUS LOCATION FLOOD LIGHTS

Class I, Division 2, Groups A, B, C, D

Non recessed Marine luminaires, outside type (salt water)

The CDHF2 LED flood lights are specifically engineered for use in hazardous environments containing flammable vapors or gases. This series is designed for locations prone to vibrations, as well as NEMA 4X environments characterized by exposure to wind, water, snow, or high ambient temperatures.

FEATURES AND SPECIFICATIONS

• Construction

Physical Characteristics

- Rugged and resilient housing made of a aluminum-alloy material available in a grey housing finish.
- All exposed fasteners are quality stainless steel.

Temperature ratings

Based on the surface temperature of the fixture:

- Class I, Division 2 is rated:
 - T5 (will not exceed 100 °C) for 30 W models
 - T4A (will not exceed 120 °C) for 60 W, 100 W, 150 W (120-277 V), 240 W and 300 W models
 - T4 (will not exceed 135 °C) for 150 W (277-480 V), 200 W, 300 W and 400 W models

Ambient operating temperature

- -40 °C to +60 °C for 30 W and 300 W (277-480 V) models
- -40 °C to +55 °C for 60 W, 100 W, 150 W, 200 W, 240 W, 300 W (120-277 V) models
- -40 °C to +50 °C for 400 W models

Ambient operating humidity

10 % to 90 % RH

Mounting types

Standard mounting type is pendant mount including a safety cable and this series offers the following accessories:

- Yoke mount (wall/ground or ceiling applications)
- Side surface mount
- Slipfitter with wall/pole adapter
- Chain mount
- Slipfitter (inner Ø 2.60")
- Pole mounting
- Adjustable arm for square/round pole
- Junction box

Lens/Optics

Comes standard with a thermal shock and impact resistant tempered glass lens available in beam angles of 23 degrees, 110 degrees and Nema 7Hx6V.

• Performance data

- Available in a 2 700 K, 3 000 K, 4 000 K, 5 000 K, 5 700 K and 6 500 K color temperatures
- 70+ CRI
- Estimated life L70 >60 000
- Electrical ratings: 120-277 V 50/60 Hz and 277-480 V 50/60 Hz for 150 W, 300 W and 400 W lumen packages
- 0-10 V dimming standard
- Built-in DM 6 kV (line-line) and a CM 10 kV (line-earth)
- Power factor of ≥0.9
- THD of ≤20 %

• Suitable for zone ratings:

- Zone 2, Group IIC

• Compliances

- Meets requirements of ICES-005 issue 5 class A for use in commercial applications
- IP66
- IK08
- NEMA 4X
- 3G vibration resistant in compliance with ANSI/IEEE C136.31 standard for luminaire vibration
- UL 1598A
- UL 1598
- UL 8750
- UL 844
- CSA C22.2 No.137
- CSA C22.2 No.250.0
- CSA C22.2 No.250.13



30 W-60 W



100 W-150 W



200 W-240 W



300 W-400 W



quick ship



LED fixture



dimmable fixture



wet location



hazardous location



IK08



ICES 005

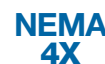

OVERVIEW

Light source	LED
Watts (W)	30, 60, 100, 150, 200, 240, 300, 400
Lumen output (lm)	4 275 - 64 800
Efficacy (lm/W)	135 - 166
Color temperature (K)	2 700, 3 000, 4 000, 5 000, 5 700, 6 500
CRI	70+

QUICK SHIP AND TECHNICAL SPECIFICATION TABLE 

Order code	Model number	Watts	Volts	Color temps.	Lumen output	Efficacy	CRI	Life L70	Tested hours LM-80	Beam angle	B.U.G rating	LED current	Finish	Power factor	THD
		(W)	(V)	(K) ¹	(LM) ^{2,3}	(LM/W)	(hrs) ⁴	(hrs) ⁴	(°)	(MA)	(%)				
70278	CDHF2-S2-W3-W-40-GY	60	120-277	4 000	9 724	157	70+	60 000	10 000	110	B3-U2-G1	662	Grey	≥0.9	≤20
70279	CDHF2-S3-W3-W-40-GY	100	120-277	4 000	16 879	164	70+	60 000	10 000	110	B3-U2-G1	810	Grey	≥0.9	≤20

¹ Typical color temperature range: +/- 5 %.

² Lumen values are derived from photometric testing. Initial lumens range: +/- 10 %.

³ Lumen values are based on 4 000 K default programming. Please refer to the LUMEN SPECIFICATION TABLE for more details on other color temperatures.

⁴ Life hours are derived from IESNA LM-80 testing report and projected per IESNA TM-21 extrapolations.

ORDERING GUIDE

Series	Lumen package (W)	Beam angle	Volts (V)	Color temperature (K)	Casting color
CDHF2	S1 - 30 S2 - 60 S3 - 100 S5 - 200 S6 - 240 S4 - 150 S7 - 300 S8 - 400	N2 - 23° W3 - 110° VW1 - 7Hx6V	W - 120-277 W - 120-277 K - 277-480	27 - 2 700 30 - 3 000 40 - 4 000 50 - 5 000 57 - 5 700 65 - 6 500	GY - Grey

LUMEN SPECIFICATION TABLE

Watts (W)	Beam angle	Volts (V)	Fixture current (A)	4 000 K		CRI	Life L70 (hrs)	Power factor	THD (%)
				Lumen output (lm)	Efficacy (lm/W)				
30	23°	120-277	0.35	4 275	140	>70	>60 000	≥0.9	≤20
60		120-277	0.65	7 973	135	>70	>60 000	≥0.9	≤20
100		120-277	1.1	14 595	144	>70	>60 000	≥0.9	≤20
150		120-277	1.65	21 102	140	>70	>60 000	≥0.9	≤20
150		277-480	0.6	21 176	141	>70	>60 000	≥0.9	≤20
200		120-277	2.2	29 297	145	>70	>60 000	≥0.9	≤20
240		120-277	2.6	34 817	142	>70	>60 000	≥0.9	≤20
300		120-277	3.3	42 000	140	>70	>60 000	≥0.9	≤20
300		277-480	1.2	42 300	141	>70	>60 000	≥0.9	≤20
400		120-277	4.4	56 400	141	>70	>60 000	≥0.9	≤20
400		277-480	1.6	56 000	140	>70	>60 000	≥0.9	≤20
30		110°	120-277	0.35	4 852	162	>70	>60 000	≥0.9
60	120-277		0.65	9 724	157	>70	>60 000	≥0.9	≤20
100	120-277		1.1	16 879	164	>70	>60 000	≥0.9	≤20
150	120-277		1.65	25 212	163	>70	>60 000	≥0.9	≤20
150	277-480		0.6	24 813	156	>70	>60 000	≥0.9	≤20
200	120-277		2.2	33 855	166	>70	>60 000	≥0.9	≤20
240	120-277		2.6	38 570	158	>70	>60 000	≥0.9	≤20
300	120-277		3.3	48 300	161	>70	>60 000	≥0.9	≤20
300	277-480		1.2	47 400	158	>70	>60 000	≥0.9	≤20
400	120-277		4.4	64 800	162	>70	>60 000	≥0.9	≤20
400	277-480		1.6	62 400	156	>70	>60 000	≥0.9	≤20
30	7Hx6V		120-277	0.35	4 851	162	>70	>60 000	≥0.9
60		120-277	0.65	9 712	156	>70	>60 000	≥0.9	≤20
100		120-277	1.1	16 608	162	>70	>60 000	≥0.9	≤20
150		120-277	1.65	24 671	160	>70	>60 000	≥0.9	≤20
150		277-480	0.6	24 863	157	>70	>60 000	≥0.9	≤20
200		120-277	2.2	33 279	163	>70	>60 000	≥0.9	≤20
240		120-277	2.6	38 040	156	>70	>60 000	≥0.9	≤20
300		120-277	3.3	47 700	159	>70	>60 000	≥0.9	≤20
300		277-480	1.2	46 500	155	>70	>60 000	≥0.9	≤20
400		120-277	4.4	64 000	160	>70	>60 000	≥0.9	≤20
400		277-480	1.6	61 600	154	>70	>60 000	≥0.9	≤20

Data is based upon tests performed in a controlled environment. Actual performance can vary depending on operating conditions. All products are subject to change or may be discontinued any time without notice.

QUICK SHIP ACCESSORIES ⚡

Order code	Type
70298	Yoke mount for 30 and 60 W models (for ceiling applications)
70299	Yoke mount for 100 and 150 W models (for ceiling applications)
70302 ¹	Junction box

¹ Hazloc pipe and fittings not supplied.

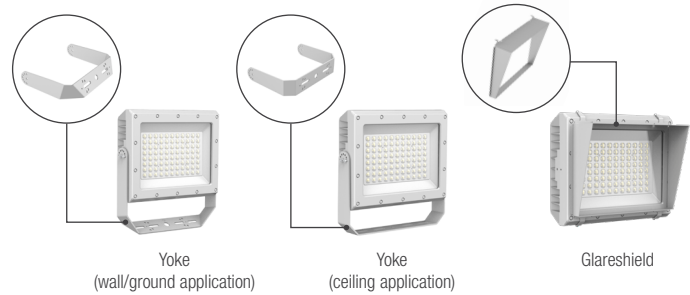

ACCESSORIES (order separately)

Order code	Type
70341	Yoke mount for 30 and 60 W models (for wall/ground applications)
70342	Yoke mount for 100 and 150 W models (for wall/ground applications)
70343	Yoke mount for 200 and 240 W models (for wall/ground applications)
70344	Yoke mount for 300 and 400 W models (for wall/ground applications)
70345	Yoke mount for 200 and 240 W models (for ceiling applications)
70346	Yoke mount for 300 and 400 W models (for ceiling applications)
70347	Glareshield for 30 and 60 W models
70348	Glareshield for 100 and 150 W models
70349	Glareshield for 200 and 240 W models
70350	Glareshield for 300 and 400 W models
70351	Wireguard for 30 and 60 W models
70352	Wireguard for 100 and 150 W models
70353	Wireguard for 200 and 240 W models
70354	Wireguard for 300 and 400 W models
70355	Pole mounting for 30 and 60 W models
70356	Pole mounting for 100 and 150 W models
70357	Pole mounting for 200 and 240 W models
70358	Pole mounting for 300 and 400 W models
70359	Slipfitter
70360	Adjustable arm for square/round pole
70361	Slipfitter with wall/pole adapter
70362	Side surface mount
70363	Chain mount

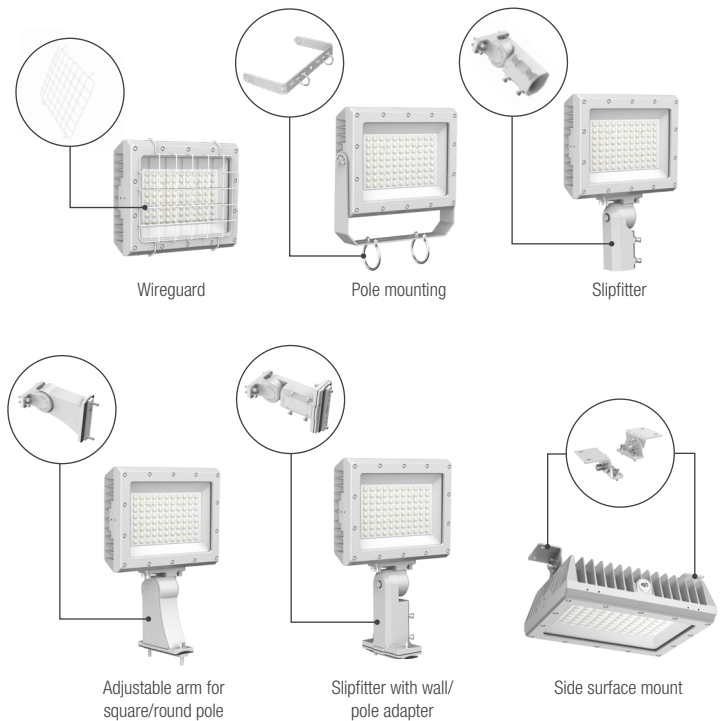

COMPATIBLE DIMMERS¹

Brand	Model
Leviton	DS710
Lutron	NTSTV-DV, NFTV, DVSTV

Dimming range: 0%-100%

¹ This table shows dimmers that have been tested and have demonstrated proper operation under normal conditions. Each installation being unique, various factors such as load, common neutrals or other electrical products on the circuit can, in certain instances, cause variance in system performance. Read and comply to the dimmer installation instructions. Consult dimming system manufacturer for additional support in operation. Some dimmers may require more than one product for stable operation. Stanpro recommends to use dimmers designed to work with LED products. Older dimmers designed for incandescent products may cause erratic operation.

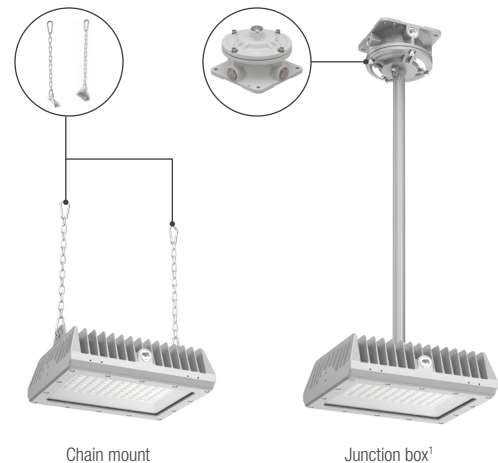

Data is based upon tests performed in a controlled environment. Actual performance can vary depending on operating conditions. All products are subject to change or may be discontinued any time without notice.

DRILLING PATTERNS

Adjustable arm for square/round pole
70360

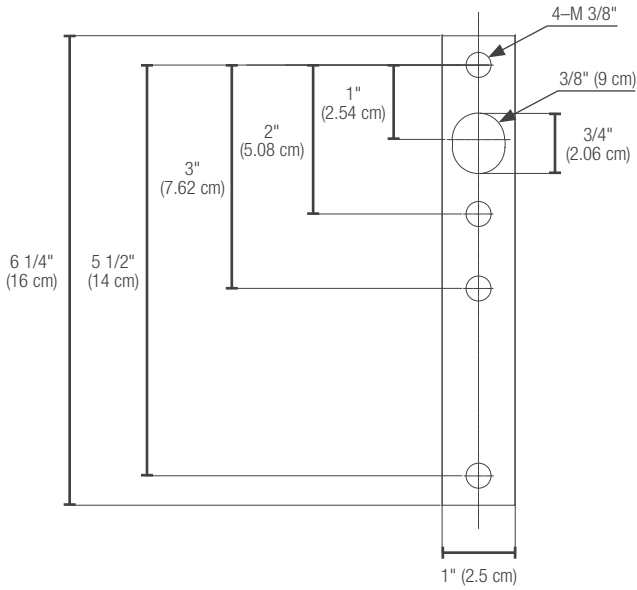

Slipfitter with wall/pole adapter
70361

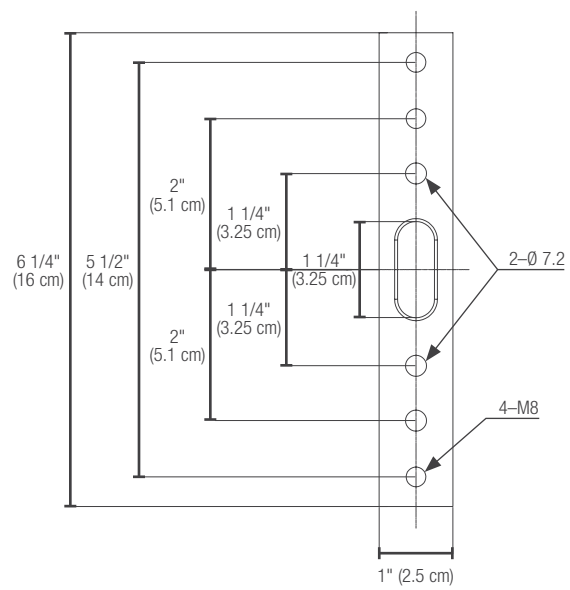

DIMENSIONS AND WEIGHTS

PENDANT MOUNT

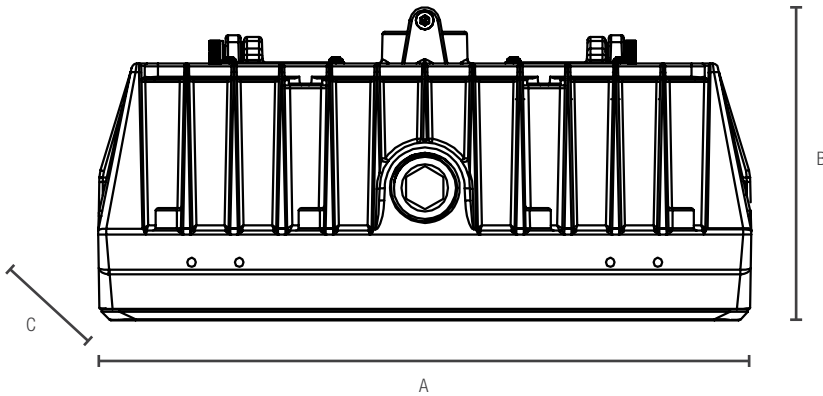

	30 W	60 W	100 W	150 W	200 W	240 W	300 W	400 W
A in. (cm)	9 5/8 (24.5)	12 7/8 (32.7)	15 5/8 (39.7)	19 3/4 (50.1)				
B in. (cm)	7 1/4 (18.4)	10 3/8 (26.5)	12 1/2 (31.7)	14 3/4 (37.3)				
C in. (cm)	4 5/8 (11.7)	4 7/8 (12.3)	5 1/8 (12.9)	5 3/4 (14.5)				
Net weight (lbs)	12.79	13.23	21.16	21.61	31.09	31.31	48.50	50.70

Data is based upon tests performed in a controlled environment. Actual performance can vary depending on operating conditions. All products are subject to change or may be discontinued any time without notice.