

Series Spec Sheet

PRMXL

ALUMINUM COMBO

NBC2015 Compliant

The PRMXL series of commercial combination extruded signs and battery units features a fully modern appearance. The extruded aluminum design provides for a rigid, durable and lightweight sign. Two PAR18 small style, front mounted heads are standard, MR16 type are optional. Available with either 6 VDC or 12 VDC.

FEATURES AND SPECIFICATIONS

• Circuitry

- LED ultra bright light source
- 120/347 VAC field selectable, or 277 VAC
- 1.8 W power consumption for LED exit portion of combination sign
- LED Emergency DC wattages as follows:
6 VDC = 0.9 W 12 VDC = 0.86 W
- Wattage capacities from 36 to 72 W
- 30 minutes emergency power duration standard
- Momentary push button test switch
- Pilot LEDs for AC ON and CHARGE
- Fully automatic, constant voltage current limited charger
- Solid state design and construction with brownout and short circuit protection
- Temperature compensated
- Maintenance free, sealed lead acid battery

• Mechanical

- Extruded aluminum construction
- Slide in/out captive faceplate(s) and backplate for rapid and simplified installation
- Universal spider knockout pattern stamped into backplate for junction box mounting
- Universal models include ceiling or end mount, field installable canopy kit c/w spider plate
- Multiple conduit entry knockouts
- White powder coat finish standard, other finishes and colors optional
- Front head mounted is standard, side mount is optional

• Approvals

- CSA Certified to C22.2 #141-15
- CSA Certified to C860-11

• Compliance

- Meets requirements of ICES-005



OVERVIEW

| | |
|-------------------------|--|
| Light Source | LED |
| Input voltage (VAC) | 120/347 or 277 |
| Sign Power consumption | 120 V = 1.80 W 347 V = 1.70 W 277 V = 1.40 W |
| Sign DC voltage/wattage | 6 VDC = 0.9 12 VDC = 0.86 |
| Output volts (VDC) | 6, 12 |
| Power capacity (W) | 36 - 72 |



LED
fixture



ICES
005



link
compatible



Energy Verified
Energie Vérifiée

ORDERING GUIDE

| PRMXL | | | | | | | | |
|--------------|-----------|----------------------------------|------------------------------------|-------------------------------|--|--------------------------------|----------------------------|---|
| Series | Volts (V) | Watts (W) | Nbr of faces | Nbr of heads | Head/Lamp | Lamp | Input voltage (VAC) | Options |
| PRMXL | 6 - 6 | 036 - 36 050 - 50 | 1 - Single face 2 - Double face | 00 - No head | Blank - No heads | See lamp selection chart below | Blank - 120/347 E - 277 | AT, AUD ¹ , AUE, BO, LD, OP, PG, TP, WGD, WO 0 - No indicators (double face only) ↓ ↑ ↗ ↘ ↙ ↘ D U UR DR DL UL |
| | 1 - 12 | 036 - 36 050 - 50 072 - 72 | | 1 - One head 2 - Two heads | N - PAR18 (standard) S - MR16 M - MR16 | | | |

¹ Only available with AT.

EMERGENCY LIGHTING OPTIONS

| Option | Description |
|--------|---------------------------------|
| AT | Automatic test Self-diagnostic |
| AUD | Audible Diagnostic ¹ |
| AUE | Audible Emergency |
| BO | Black Out Option |
| LD | Lamp Disconnect (internal) |
| OP | Special Wording |
| PG | Lexan Guard (separate order) |
| TP | Tamper Proof Screws |
| WGD | Wireguard (separate order) |
| WO | White Out Option |

¹ Only available with AT.

WIREGUARD¹

| | | Part number | Dimensions (in) |
|--------------|---------------|-------------|------------------|
| Without head | Wall mount | WGD590 | 15.25x14.25x6.75 |
| | Ceiling mount | WGD650 | 13.75x12.25x16.5 |
| | End mount | WGD650 | 13.75x12.25x16.5 |
| With head(s) | Wall mount | WGD590 | 15.25x14.25x6.75 |
| | Ceiling mount | WGD650 | 13.75x12.25x16.5 |
| | End mount | WGD650 | 13.75x12.25x16.5 |

¹ Please contact your Stanpro customer service representative for more information.

LAMP SELECTION

| | 6 V | 12 V |
|----------------------------|---------------|-------------------------|
| PAR18 • Small head | | |
| LED | 3LJ, 4LJ, 5LJ | 3LJ, 4LJ, 5LJ, 6LA, 7LA |
| Quartz halogen | 10Q | 10Q, 12Q |
| Tungsten | 09T | 09T |
| MR16 • Small head c/w MR16 | | |
| LED | 4LR, 5LA | 4LR, 5LA, 6LA, 7LA |
| Quartz halogen | 10Q | 10Q, 12Q, 35Q |

MODEL RATINGS

| Model | Volts (V) | Wattage capacities (W) | | | |
|-----------|-----------|------------------------|---------|---------|----------|
| | | 30 min. | 60 min. | 90 min. | 120 min. |
| PRMXL6036 | 6 | 36 | 18 | 12 | 9 |
| PRMXL6050 | 6 | 50 | 25 | 16 | 12 |
| PRMXL1036 | 12 | 36 | 18 | 12 | 9 |
| PRMXL1050 | 12 | 50 | 25 | 16 | 12 |
| PRMXL1072 | 12 | 72 | 36 | 24 | 18 |

Data is based upon tests performed in a controlled environment. Actual performance can vary depending on operating conditions. All products are subject to change or may be discontinued any time without notice.

SPACING GUIDE

| Mounting height | Spacing center to center (ft) | | | | | | |
|-----------------|-------------------------------|------|------|------|------|------|------|
| | 3WLJ | 4WLJ | 5WLJ | 4WLR | 5WLA | 6WLA | 7WLA |
| 8 ft | 78 | 83 | 118 | 76 | 81 | 94 | 108 |
| 10 ft | 75 | 76 | 118 | 79 | 79 | 93 | 106 |
| 15 ft | 66 | 68 | 104 | 66 | 62 | 82 | 96 |
| 20 ft | 53 | 53 | 91 | 53 | 49 | 73 | 87 |

DIMENSIONS

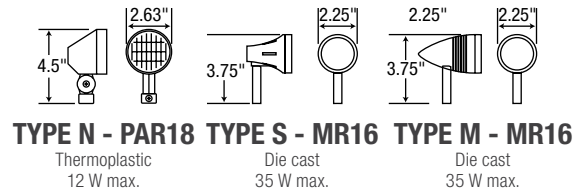
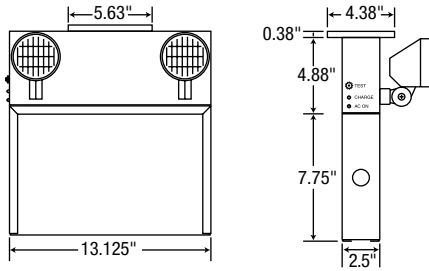

CONFIGURATION



Comes standard (single face) with three pictogram legends for direction selection.



Comes standard (double face) with two pictogram legends.



For double face no arrow options, select "0" on the options column.

Data is based upon tests performed in a controlled environment. Actual performance can vary depending on operating conditions. All products are subject to change or may be discontinued any time without notice.