

PROJECT:

DATE:

DISTRIBUTOR:

CATALOGUE #:

TYPE:

DRAWN BY:

CONTRACTOR:

PO:



PRMXL ALUMINUM COMBO

STANPRO

SPEC SHEET

FEATURES AND SPECIFICATIONS

CIRCUITRY

- LED ultra bright light source
- 120/347 V AC field selectable, or 277 V AC
- 1.8 W power consumption for LED exit portion of combination sign
- LED Emergency DC wattages as follows:
 - **6 V DC** = 0.9 W, **12 V DC** = 0.86 W
- Wattage capacities from 36 to 72 W
- 30 minutes emergency power duration standard
- Momentary push button test switch
- Pilot LEDs for AC ON and CHARGE
- Fully automatic, constant voltage current limited charger
- Solid state design and construction with brownout and short circuit protection
- Temperature compensated
- Maintenance free, sealed lead acid battery

BLUETOOTH CONTROL

- Integrated Bluetooth technology allows for controllable features via the Stanpro Genio App
- Controllable features include:
 - Instantly view and control individual lights and emergency devices
 - Easily group luminaires together and control them as a single unit
 - Schedule functional and discharge tests at a chosen time
 - Generate, view and share reports seamlessly with just a few clicks

MECHANICAL

- Extruded aluminum construction
- Slide in/out captive faceplate(s) and backplate for rapid and simplified installation
- Universal spider knockout pattern stamped into backplate for junction box mounting
- Universal models include ceiling or end mount, field installable canopy kit c/w spider plate
- Multiple conduit entry knockouts
- White powder coat finish standard, other finishes and colors optional
- Front head mounted is standard, side mount is optional

APPROVALS

- CSA Certified to C22.2 #141-15
- CSA Certified to C860-11

COMPLIANCE

- Meets requirements of ICES-005

TECHNICAL DRAWINGS

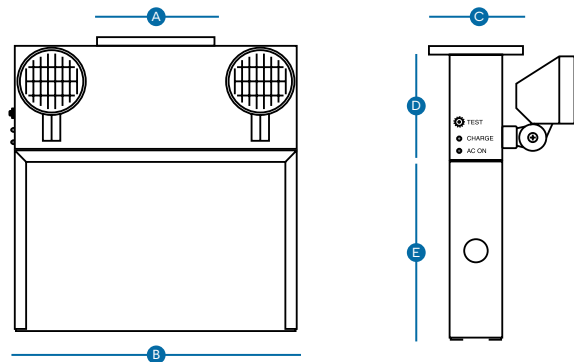

TYPE N - PAR18

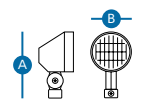

TYPE S - MR16

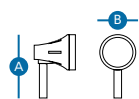

TYPE M - MR16

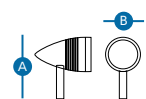

Type	A	B	C	D	E
Combo	5 5/8" (14.30 cm)	13 1/8" (33.34 cm)	4 3/8" (11.13 cm)	4 7/8" (12.40 cm)	7 3/4" (19.68 cm)
Type N PAR18	4 1/2" (8.92 cm)	2 5/8" (6.68 cm)	-	-	-
Type S MR16	3 3/4" (9.53 cm)	2 1/4" (5.72 cm)	-	-	-
Type M MR16	3 3/4" (9.53 cm)	2 1/4" (5.72 cm)	-	-	-

* Please refer to the product web page to view detailed drawings by size.



ICES
005



TYPICAL SPECIFICATION

Supply and install Stanpro's Extruded PRMXL Running Man and Battery combination unit. The sign shall be Extruded Aluminum Running Man Exit Signs. The sign shall operate with AC/DC field selectable 120/277/347 V AC. The face shall be illuminated by using Nichia LED ultra-bright light source. The sign shall be suitable for wall, end, or ceiling mount and come complete with 3 Running Man fibers for universal direction. The sign shall be CSA C22.2 141-15 and ICES compliant.

The battery unit shall be rated 120 V, 277 V or 347 V, 60 Hz constructed of durable 18-gauge steel and be CSA listed to C22.2 141-15 and be ICES 005 compliant. The unit shall have an output of: __V and __W and come complete with (0), (1) or (2) x __W LED heads producing (__) lumens each. The charge voltage factory set to ± 1% tolerance. High efficiency, rapid recovery, precision control charging system shall be employed to promote long battery life and reduce the potential for grid corrosion. The unit shall also feature integrated Bluetooth connectivity for monitoring and configuration of the system, allowing users to view system status and perform diagnostics via a mobile app. The charger shall provide a continuous high charge to recharge the battery, when the battery is at full capacity, the charger will shut-off. Periodically the charger shall provide a pulse of energy to keep the battery at full voltage. The pulse charger shall be precisely regulated and shall charge the battery in relation to its temperature, state of charge and input voltage fluctuations. The charger shall be current limited, temperature compensated, short-circuit proof and reverse polarity protected. The unit shall be furnished with an electronic lockout circuit, which will connect the battery when the AC circuit is activated, and an electronic brownout circuit, which will activate the emergency lights when utility power dips below 75% of nominal voltage. A low voltage battery protection circuit shall be provided and will disconnect the load when the battery reaches the end of discharge. The Stanpro Sign and Battery combination unit shall be PRMXL _____.

ORDERING GUIDE

Dropdown selections may not display correctly in web browsers. For full functionality, please download the file to use all features.

PRMXL									
Series	Volts (V)	Watts (W)	Number of Faces	Number of Heads	Head / Lamp	Lamp	Color	Input Voltage (V)	Options
PRMXL	6 6	036 36 050 50	1 Single Face 2 Double Face	00 No Heads	Blank No Heads	See lamp list below only 6 V and 12 V	BK Black WH White GY Grey	Blank 120/347 E 277	AT, AUD ¹ , AUE, LD, RFS, SMH, TD ¹ , BT (Bluetooth Genio option)
	1 12	036 36 050 50 072 72		1 One Head 2 Two Heads	N PAR18/MR16 S MR16 L PAR36 M MR16				0 No indicators (double face only) ↓ ↑ ↗ ↘ ↙ ↘ D U UR DR DL UL

¹Only available with AT and BT.

EMERGENCY LIGHTING OPTIONS

Option	Description
AT	Automatic test self-diagnostic
AUD	Audible alarm
AUE	Audible emergency
LD	Lamp disconnect (internal)
RFS	Radio frequency suppression
SMH	Side mounted heads
TD	Time delay

LUMEN TABLE

Watts	Lumens
3W LJ	313
4W LJ	388
5W LJ	590
4W LR	388
5W LA	435
6W LA	507
7W LA	652

SMART OPTIONS

LEXAN GUARD

Option	Description
BT	Genio Bluetooth

	Model Number	Dimensions (in)
Wall Mount	PGD111	19.75 x 14 x 8
Ceiling Mount	PGD100	16 x 10 x 13.5

WIREGUARD¹

LAMP SELECTION

		Model Number	Dimensions (in)
Without head	Wall mount	WGD590-V2	16.75 x 17.75 x 6.5
	Ceiling mount	WGD650-V2	17.75 x 17.75 x 16.50
	End mount	WGD650-V2	17.75 x 17.75 x 16.50
With head(s)	Wall mount	WGD510-V2	19.75 x 19.75 x 7.25
	Ceiling mount	WGD650-V2	17.75 x 17.75 x 16.50
	End mount	WGD650-V2	17.75 x 17.75 x 16.50

	6 V	12 V
PAR18 • Small head		
LED	3LJ, 4LJ, 5LJ	3LJ, 4LJ, 5LJ, 6LA, 7LA
Tungsten	09T	09T
MR16 • Small head c/w MR16		
LED	4LR, 5LA	4LR, 5LA, 6LA, 7LA

¹Please contact your Stanpro customer service representative for more information.

MODEL RATINGS

SPACING GUIDE

Model	Volts (V)	Wattage Capacities (W)			
		30 min.	60 min.	90 min.	120 min.
PRMXL6036	6	36	18	12	9
PRMXL6050	6	50	25	16	12
PRMXL1036	12	36	18	12	9
PRMXL1050	12	50	25	16	12
PRMXL1072	12	72	36	24	18

Mounting Height	Spacing Center to Center (ft)						
	3LJ	4LJ	5LJ	4LR	5LA	6LA	7LA
8 ft	78	83	118	76	81	94	108
10 ft	75	76	118	79	79	93	106
15 ft	66	68	104	66	62	82	96
20 ft	53	53	91	53	49	73	87

CONFIGURATIONS



Comes standard (single face) with three pictogram legends for direction selection.



Comes standard (double face) with two pictogram legends.



For double face no arrow options, select "0" on the options column.