

LED WALL SCONCE - TRADITIONAL

1, 2, 3 or 4 modules

Our LED Wall Sconces adapt to a variety of applications, as they are available in several different sizes and color temperatures of 3 000 K and 4 000 K. These luminaires operate on line voltage and provide a diffused direct lighting, as well as a 120° angled upward and downward lighting. These Wall Sconce Luminaires come equipped with double-sided frosted lenses and depending on the desired look, they can be installed with a glossy or matte lens finish.

FEATURES AND SPECIFICATIONS

• Construction

Finish

- Brushed Nickel Finish
- Single, Double, Triple and Quadruple Module
- Frosted double-sided lens – Glossy or matte finish

Mounting

Easy mounting with mounting palte and installation gear included

• Technical specifications

- 120 VAC
- 10, 20, 30 and 40 W
- Forward and phase dimming
- Suitable for damp location
- IP44

• Compliances

- ETL
- Meets requirements of ICES-005 Class B
- FCC

OVERVIEW

| | |
|-----------------------|--------------|
| Light source | LED |
| Watts (W) | 10 - 40 |
| Lumen output (lm) | 628 - 2 579 |
| Efficiency (lm/W) | 61 - 67 |
| Color temperature (K) | 3 000, 4 000 |
| CRI | 90 |



QUICK SHIP AND TECHNICAL SPECIFICATION TABLE

| Order code | Part number | Watts (W) | Volts (VAC) | Color temp. (K) ² | Lumen output (lm) ³ | Efficiency (lm/W) | CRI | Life L70 (hrs) ⁴ | Housing Finish | Lens Finish | Beam angle (°) | Dimming (Yes/No) | Power factor | THD (%) | Case qty (master) |
|------------------|------------------------------|-----------|-------------|------------------------------|--------------------------------|-------------------|-----|-----------------------------|----------------|-------------|----------------|------------------|--------------|---------|-------------------|
| Single | | | | | | | | | | | | | | | |
| 65838 | SVAN/SINGLE/10W/30K/BN/F/STD | 10 | 120 | 3 000 | 628 | 63 | 90 | 50 000 | Brushed nickel | Frosted | 120 | Yes | >0.9 | <30 | 12 |
| 65839 | SVAN/SINGLE/10W/40K/BN/F/STD | 10 | 120 | 4 000 | 669 | 67 | 90 | 50 000 | Brushed nickel | Frosted | 120 | Yes | >0.9 | <30 | 12 |
| Double | | | | | | | | | | | | | | | |
| 65840 | SVAN/DOUBLE/20W/30K/BN/F/STD | 20 | 120 | 3 000 | 1 266 | 63 | 90 | 50 000 | Brushed nickel | Frosted | 120 | Yes | >0.9 | <30 | 12 |
| 65841 | SVAN/DOUBLE/20W/40K/BN/F/STD | 20 | 120 | 4 000 | 1 344 | 67 | 90 | 50 000 | Brushed nickel | Frosted | 120 | Yes | >0.9 | <30 | 12 |
| Triple | | | | | | | | | | | | | | | |
| 65842 | SVAN/TRIPLE/30W/30K/BN/F/STD | 30 | 120 | 3 000 | 1 917 | 64 | 90 | 50 000 | Brushed nickel | Frosted | 120 | Yes | >0.9 | <30 | 6 |
| 65843 | SVAN/TRIPLE/30W/40K/BN/F/STD | 30 | 120 | 4 000 | 2 023 | 67 | 90 | 50 000 | Brushed nickel | Frosted | 120 | Yes | >0.9 | <30 | 6 |
| Quadruple | | | | | | | | | | | | | | | |
| 65844 | SVAN/QUAD/40W/30K/BN/F/STD | 40 | 120 | 3 000 | 2 579 | 64 | 90 | 50 000 | Brushed nickel | Frosted | 120 | Yes | >0.9 | <30 | 6 |
| 65845 | SVAN/QUAD/40W/40K/BN/F/STD | 40 | 120 | 4 000 | 2 422 | 61 | 90 | 50 000 | Brushed nickel | Frosted | 120 | Yes | >0.9 | <30 | 6 |

¹ **QUICK SHIP:** Product availability is subject to change without notice. Please contact your Stanpro customer service representative to confirm inventory levels at time of order.

² Typical color temperature range: +/- 5 %.

³ Lumen values are derived from photometric testing. Initial lumens range: +/- 10 %. Please refer to Lumen Specification Table for more details on other color temperatures.

⁴ Life hours are derived from IESNA LM-80 testing report and projected per IESNA TM-21 extrapolations.

ACCESSORIES (order separately)

| Order code | Part number | Type | Finish / color | Compatible with | Case qty (inner/master) |
|------------|-----------------|---|----------------|--|-------------------------|
| 65959 | SVAN/LENS/F/STD | Lens for modular vanity and wall sconce | Frosted | 65838, 65839, 65840, 65841, 65842, 65843, 65844, 65845 | 10/200 |

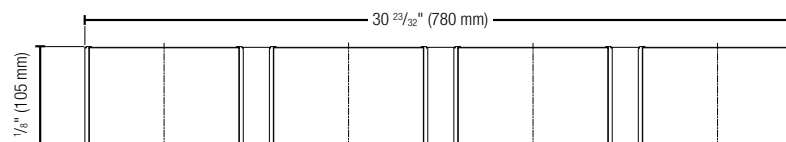
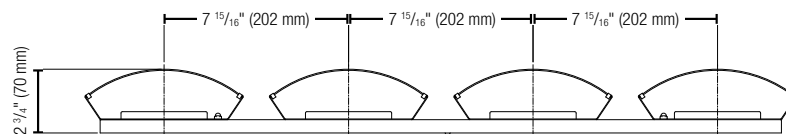
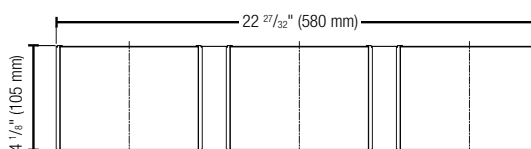
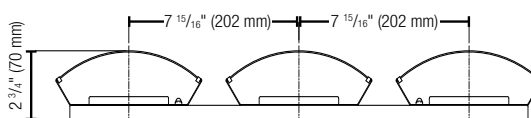
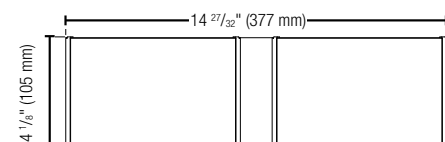
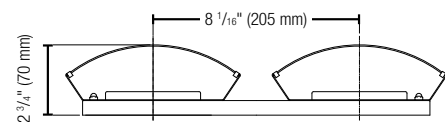
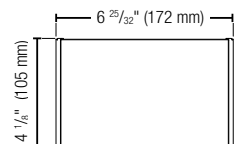
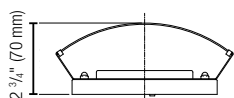
DIMENSIONS

Data is based upon tests performed in a controlled environment. Actual performance can vary depending on operating conditions.
All products are subject to change or may be discontinued any time without notice.

PHOTOMETRIC DATA¹

65838

Polar candela distribution

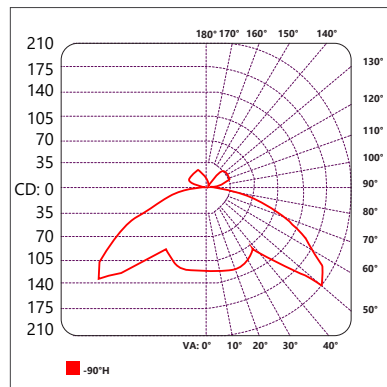

Illuminance at a distance

| Center beam fc | | Beam width | |
|----------------|---------|------------|-------|
| 2' | 31.0 fc | 5.8' | 10.7' |
| 4' | 7.8 fc | 11.6' | 21.4' |
| 6' | 3.4 fc | 17.4' | 32.2' |
| 8' | 1.9 fc | 23.2' | 42.9' |
| 10' | 1.2 fc | 29.0' | 53.6' |

■ Vert. spread: 110.8°
■ Horiz. spread: 131.1°

65840

Polar candela distribution

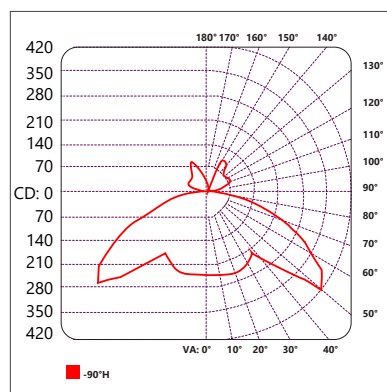

Illuminance at a distance

| Center beam fc | | Beam width | |
|----------------|---------|------------|-------|
| 2' | 62.7 fc | 5.9' | 10.9' |
| 4' | 15.7 fc | 11.6' | 21.8' |
| 6' | 7.0 fc | 17.8' | 32.6' |
| 8' | 3.9 fc | 23.7' | 43.5' |
| 10' | 2.5 fc | 29.7' | 54.4' |

■ Vert. spread: 112°
■ Horiz. spread: 139.6°

65842

Polar candela distribution

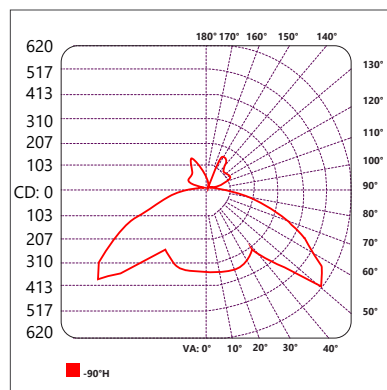

Illuminance at a distance

| Center beam fc | | Beam width | |
|----------------|---------|------------|-------|
| 2' | 95.8 fc | 6.1' | 11.6' |
| 4' | 24.0 fc | 12.1' | 23.2' |
| 6' | 10.6 fc | 18.2' | 34.8' |
| 8' | 6.0 fc | 24.2' | 46.4' |
| 10' | 3.8 fc | 30.3' | 58.0' |

■ Vert. spread: 113.1°
■ Horiz. spread: 142°

¹ Complete IES files available on our website.

Data is based upon tests performed in a controlled environment. Actual performance can vary depending on operating conditions. All products are subject to change or may be discontinued any time without notice.

PHOTOMETRIC DATA¹ (cont'd)

65844

Polar candela distribution

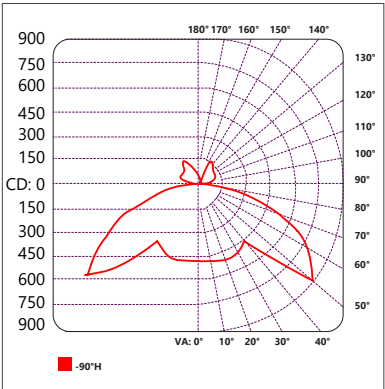

Illuminance at a distance

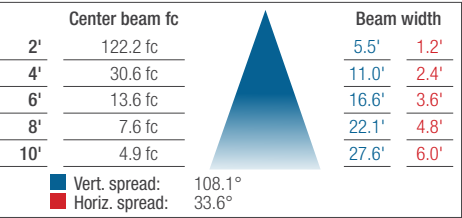

¹ Complete IES files available on our website.

Data is based upon tests performed in a controlled environment. Actual performance can vary depending on operating conditions. All products are subject to change or may be discontinued any time without notice.